

Technical Specification
Optical Fiber Cable Distribution Box
FODB-HGT-8ZX

Technical Specification

Contents

1. General	2
1.1 Description.....	2
1.2 Standards Comply.....	2
1.3 Applications Environment	2
2. Characteristics.....	3
3. Specifications.....	3
3.1 Mechanical specifications.....	3
4. Configuration	3
5.Product Picture.....	4
6.Environmental characteristics	4
7. Installation:	6
1. Wall-mounted installation	6
8.Package	6

Technical Specification

1. General

1.1 Description

The equipment is used as a termination point for the feeder cable to connect with drop cable in FTTx communication network system. The fiber splicing, splitting, distribution can be done in this box, and meanwhile it provides solid protection and management for the FTTx network building.

Production type	Classification
ALT-BOXVERT8H4-54	Optical fiber cable distribution box



Appearance of ALT-BOXVERT8H4-54

1.2 Standards Comply

The production offered by ALT are designed, manufactured and tested according to the standards as follows:

ITU-T G.652	Characteristics of a single-mode optical fibre
IEC 60794-1-1	Optical fibre cables-part 1-1: Generic specification-General
IEC 60794-1-2	Optical fibre cables-part 1-2: Generic specification-Basic optical cable test procedure

1.3 Applications Environment

Item	Value
Operation temperature	-40 °C~+65 °C
Installation temperature	-5 °C~+40 °C
Storage temperature	-40°C~+65 °C
Atmospheric pressure	70~106Kpa
Relative humidity	≤93%(+40°C)

Technical Specification

2. Characteristics

- Total enclosed structure.
- Material: PC+ABS, wet-proof, water-proof, dust-proof, anti-aging, protection level up to IP54.
- Clamping for feeder cable and drop cable, fiber splicing, fixation, storage, distribution...etc all in one.
- Cable, pigtails, patch cords are running through own path without disturbing each other, cassette type SC adaptor installation, easy maintenance.
- Distribution panel can be flipped up, feeder cable can be placed in a cup-joint way, easy for maintenance and installation.
- Cabinet can be installed by the way of wall-mounted .

3. Specifications

3.1 Mechanical specifications

Item	Specifications	Remark
External dimension(mm)	151.8*105.7*59	
Installation hole position(mm)	141	
Color	PANTONE 428C	Customizable
Size and quantity of optical cable hole	Optical cable straight through without cutting	
Input type/type of output	SC adapter	
Capacity(Max)	12 cores	
Into the largest cable diameter (mm)	∅12	
Cable outlet size(mm)	2*3~∅5	
IP protection level	IP54	
Flammability	HB(Conventional)	can be customized according to requirements
Neutral salt spray test (NSS)	48 h	

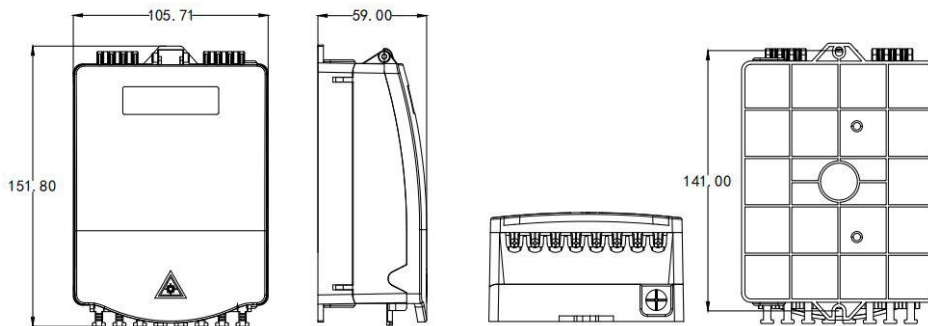

4. Configuration

Main parts

Part name	Unit	Quantity	Note
1*8 PLC Splitter	pcs	1	
SC adapter	pcs	8	

Technical Specification

5.Product Picture

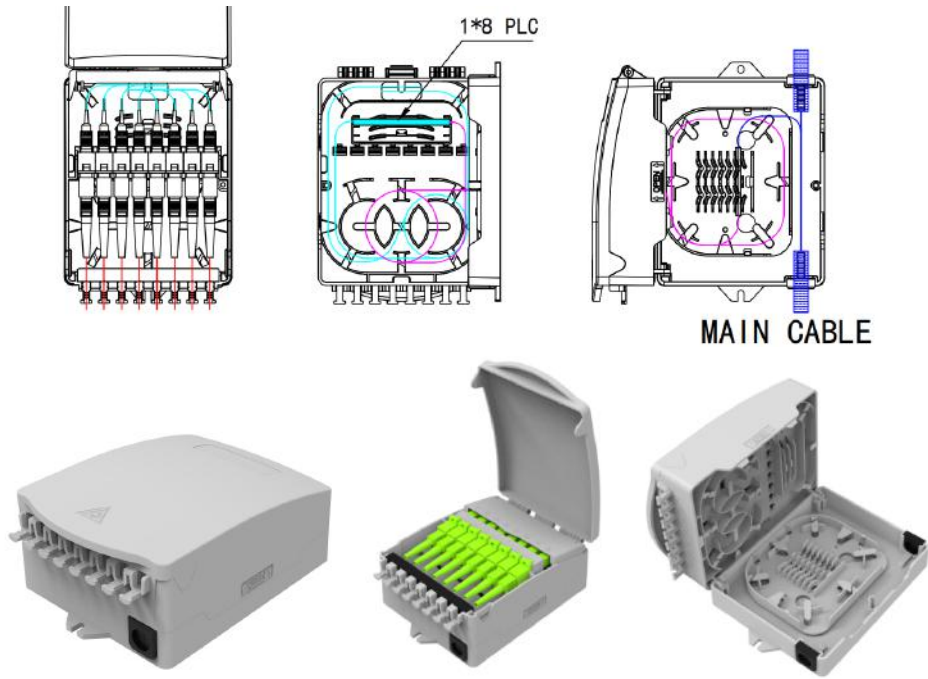

ALT-BOXVERT8H4-54 product picture

6. Installation Process

6.1 Opening the Closure

Step 1 Open the upper cover and loosen the screws.

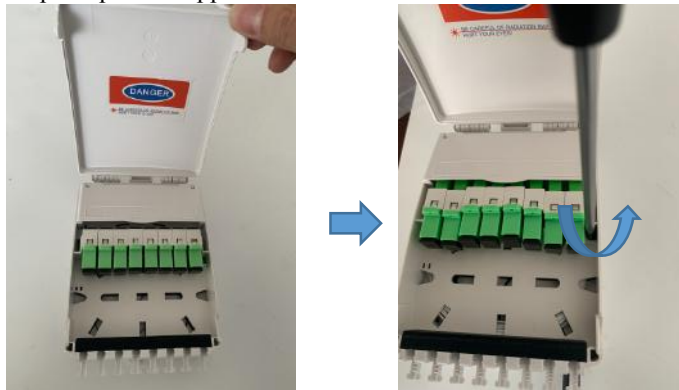

6.2 Install 1 * 8 PLC

Step 1 Remove the dust caps of adapters	Step 2 Insert the connectors.	Step 3 Remove the protective cover
---	-------------------------------	------------------------------------

Technical Specification

Step 4 Route the pigtails in the splicing trays.		Step 5 Install the protective cover back	

6.3 Strip, Lead in, and Secure Optical Cables

Step 1 Strip optical cable	Step 2 Cut rubber plug	Step 3 Lead in and Secure Round Type Cable
Step 4 Splice and Route Optical Fibers	Step 5 Strip the bare fiber to fiber core and splice the fiber with the pigtail.	
Step 6 Close the buckles and fasten the screw.	Step 7 Insert the patch cord into the adapter	Step 8 Fix the patch cord in the box

6.4 Close lid

Step 1 Close the buckles.

Technical Specification

7.Environmental characteristics

This product complies with the RoHS environmental protection directive, and the content of lead, cadmium, mercury, hexavalent chromium, polybrominated biphenyl (PBB) and polybrominated diphenyl ether (PBDE) does not exceed the limit.

8. Wall-mounted installation

Step 1 Drill 2 holes on the wall according to the size shown in the drawing.

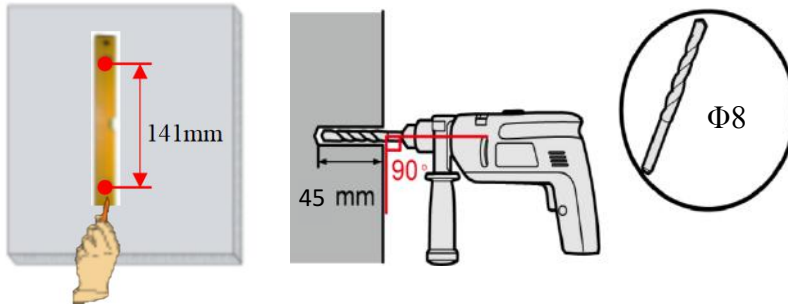

Step 2 Install the expansion bolts $\Phi 8*40$.



Step 3 Place the box to match up the holes and use screws to fasten

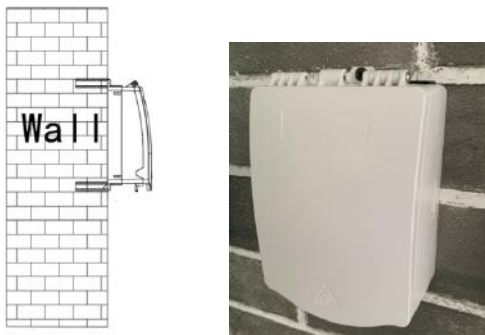

Wall mounted installation

9.Package

1 PC in a bubble bag, 220*200mm ;

1 PC in a small carton, 160*110*65mm, gross weight is 0.35 kg ;

50 PCS in a big corrugated carton, 570*340*355 mm, gross weight is 18kg.